

SAFETY AND OPERATIONS INSTRUCTIONS FROM:



PLEASE READ THIS INFORMATION CAREFULLY PRIOR TO
OPERATING EQUIPMENT

REQUIRED SAFETY EQUIPMENT



When using this tool the following safety equipment **MUST** be worn!
DO NOT USE THE MACHINE WITHOUT SAFETY EQUIPMENT



SAFETY GLASSES



SAFETY GLOVES



SAFETY MASK

SAFETY GUIDELINES -PNEUMATIC-

- Read all instructions before using the tool. All operators must be fully trained in its use and aware of these safety rules.
- **DO NOT** exceed the maximum working pressure of 100 psi
- Use **ONLY** compressed air at the recommended conditions
- If the tool appears to malfunction, remove from use immediately and arrange for service and repair
- If the tool is used with a balancer or other supporting device ensure that it is fixed securely
- Always keep hands away from the working attachment fitted to the tool
- The tool **IS NOT** electrically insulated. **NEVER** use tool if there is any chance of it coming into contact with live electricity
- When using the tool always adopt a firm footing and/or position and grip the tool firmly to be able to counteract any forces that may be generated while using the tool
- Use only the correct spare parts. Do not improvise or make temporary parts
- Do not lock, tape, wire etc the ON/OFF valve in the run position. The trigger/lever must always be free to return to the off position when it is released
- Always shut off the air supply to the tool and depress the trigger/lever to exhaust air from the feed hose before fitting, adjusting or removing the working attachment
- Check hose and fittings regularly for wear, replace if necessary
- Always use a suitable vacuum cleaner or dust extraction unit

YOUR FS050™ HAND HELD SCARIFIER

Please take time to familiarize yourself with the FS050™'s controls, as well as some of the features of your new machine.

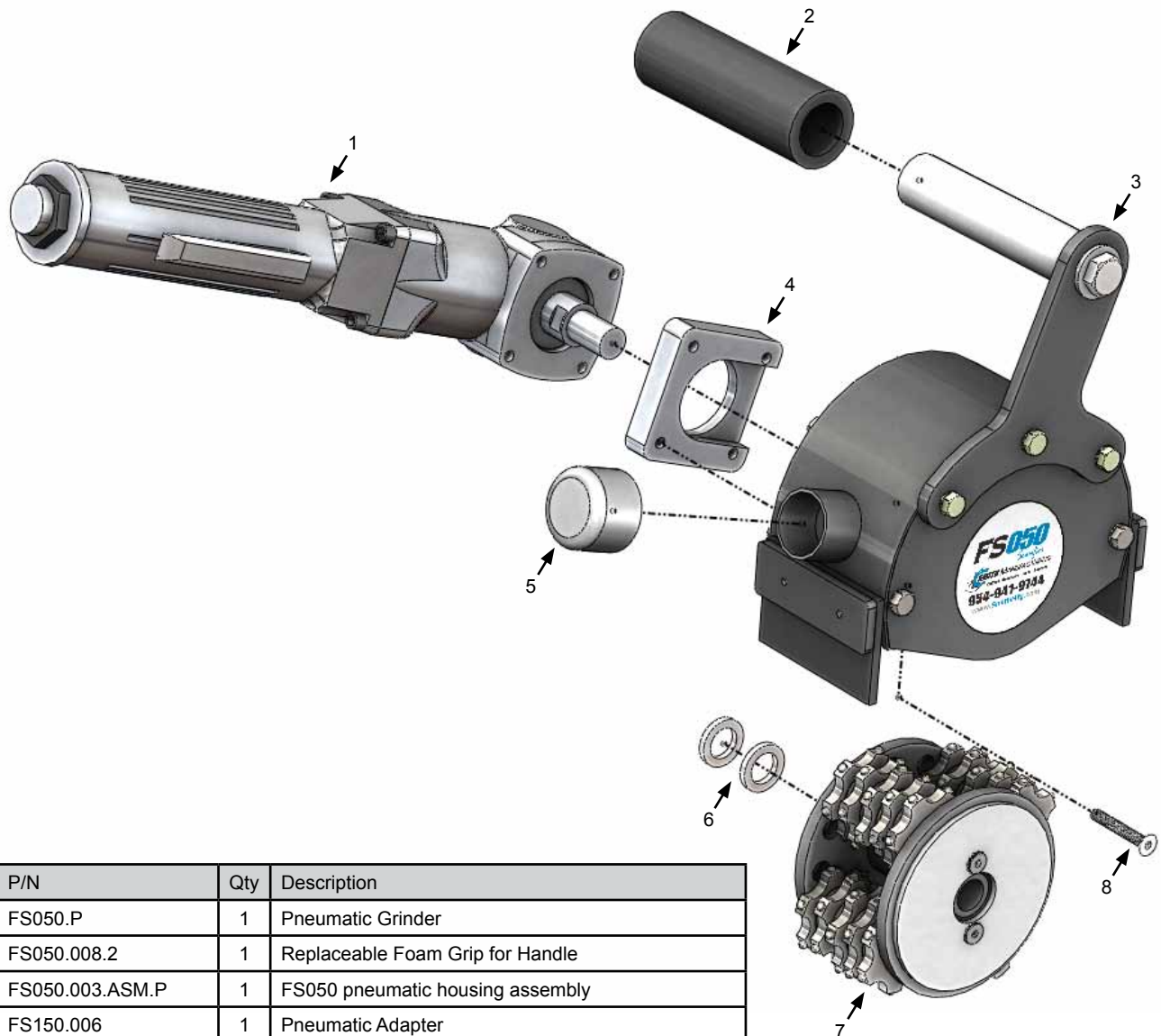

Item:	P/N	Qty	Description
1	FS050.P	1	Pneumatic Grinder
2	FS050.008.2	1	Replaceable Foam Grip for Handle
3	FS050.003.ASM.P	1	FS050 pneumatic housing assembly
4	FS150.006	1	Pneumatic Adapter
5	FS050.015	1	Vacuum Port Cap
6	FS050.001.L5A	2	Drum Offset Spacers
7	Varies	1	See FS050 Drum and cutter assemblies on pg. 7 -8
8	FHSCS.M5-0.8x35mm	4	M5x0.8x35mm Flat Head Screw

NOTE: Item 3 includes item numbers 2, 4,5,6, and 8

RECOMMENDATIONS

- Recommended working pressure:
6.3 bar / 90 psi
- Maximum working pressure:
7.0 bar / 100 psi
- Recommended hose bore:
10 mm / 3/8"
- Recommended hose length:
10 m / 30 ft.

USING THE FS050

AIR SUPPLY:

- Use clean lubricated air supply that will give a measured air pressure at the tool of **6.3 bar / 90 psi** when the tool is running with the trigger/lever depressed.
- Use the recommended hose size and length.
- Do not connect the tool to the air line system without incorporating an easy to reach an operate air shut off valve.
- The air supply should be lubricated. It is strongly recommended that an air filter, regulator, lubricator (FRL) is used as this will supply clean, lubricated air at the correct pressure for the tool.
- Details of such equipment can be obtained from your supplier/dealer. If such equipment is not used, the tool should be lubricated by shutting off the air supply to the tool and depressurizing the line by pressing the trigger on the tool.
- Disconnect the air line and pour into intake bushing a teaspoon (5 mL) of a suitable pneumatic motor lubricating oil preferably incorporating a rust inhibitor.
- Reconnect the tool to an air supply and run slowly for a few seconds to allow air to circulate the oil.
- If tool is used frequently lubricate on a daily basis and also if tool starts to lose power.

WORK STATIONS:

The tool should only be used as a hand operated tool. It is recommended that the tool is used when standing on a solid floor. It can be used in other positions but before any such use the operator must be in a secure position having a firm grip and footing and be aware of safety rules to be obeyed when using the grinder.

MAINTENANCE CHECK LIST



Before beginning servicing on any FS050 unit, DISCONNECT FROM AIR SUPPLY SOURCE

- Check all fasteners and re-tighten, since the machine will vibrate the fasteners loose if they are not secured. Use locktite.
- Clean drum housing regularly to prevent material build up.
- Inspect drum, and shafts for damage and replace as needed.
- Regularly lubricate grinder with a suitable pneumatic motor lubricating oil. Preferably one that incorporates a rust inhibitor.
- Check hose and fittings regularly for wear or leaks, replace if necessary.

SAFETY GUIDELINES -ELECTRIC-

- Accessories must be rated for at least the speed recommended on the tool warning label. Wheels and other accessories running over rated speed can fly apart and cause injury.
- Hold tool by insulated gripping surfaces when performing an operation where the cutting tool may contact hidden wiring or its own cord. Contact with a “live” wire will make exposed metal parts of the tool “live” and shock the operator.
- NEVER use tool with wood cutting blades or other saw blades. Such blades when used on a polisher frequently kick and cause loss of control leading to personal injury.
- Hold the tool firmly and keeps hands away from rotating parts.
- Make sure the drum is not contacting the work piece before the switch is turned on.
- When working near metal surfaces, watch out for flying sparks. Hold the tool so that sparks fly away from you and other persons or flammable materials.
- Do not leave the tool running. Operate the tool only when hand-held.
- Do not touch the work piece immediately after operation; it may be extremely hot and could burn your skin.
- Check that the work piece is properly supported.
- Pay attention that the wheel continues to rotate after the tool is switched off. Check hose and fittings regularly for wear, replace if necessary
- This tool has not been waterproofed, so do not use water on the work piece surface.
- Ventilate your work area adequately and use a suitable vacuum attached to the housing.
- Use of this tool to sand/grind some products, paints and wood could expose user to dust containing hazardous substances. Use appropriate respiratory protection.

YOUR FS050™ HAND HELD SCARIFIER

Please take time to familiarize yourself with the FS050™'s controls, as well as some of the features of your new machine.

There are four controls on the handheld machines

A: Button near head - Locks drive shaft for attaching/detaching drum

B: Trigger button - Turns machine on when held

C: Small button by trigger - Lock trigger into "on" position

D: Dial near trigger - Controls rpm speed of machine (1-slowest; 6-fastest)

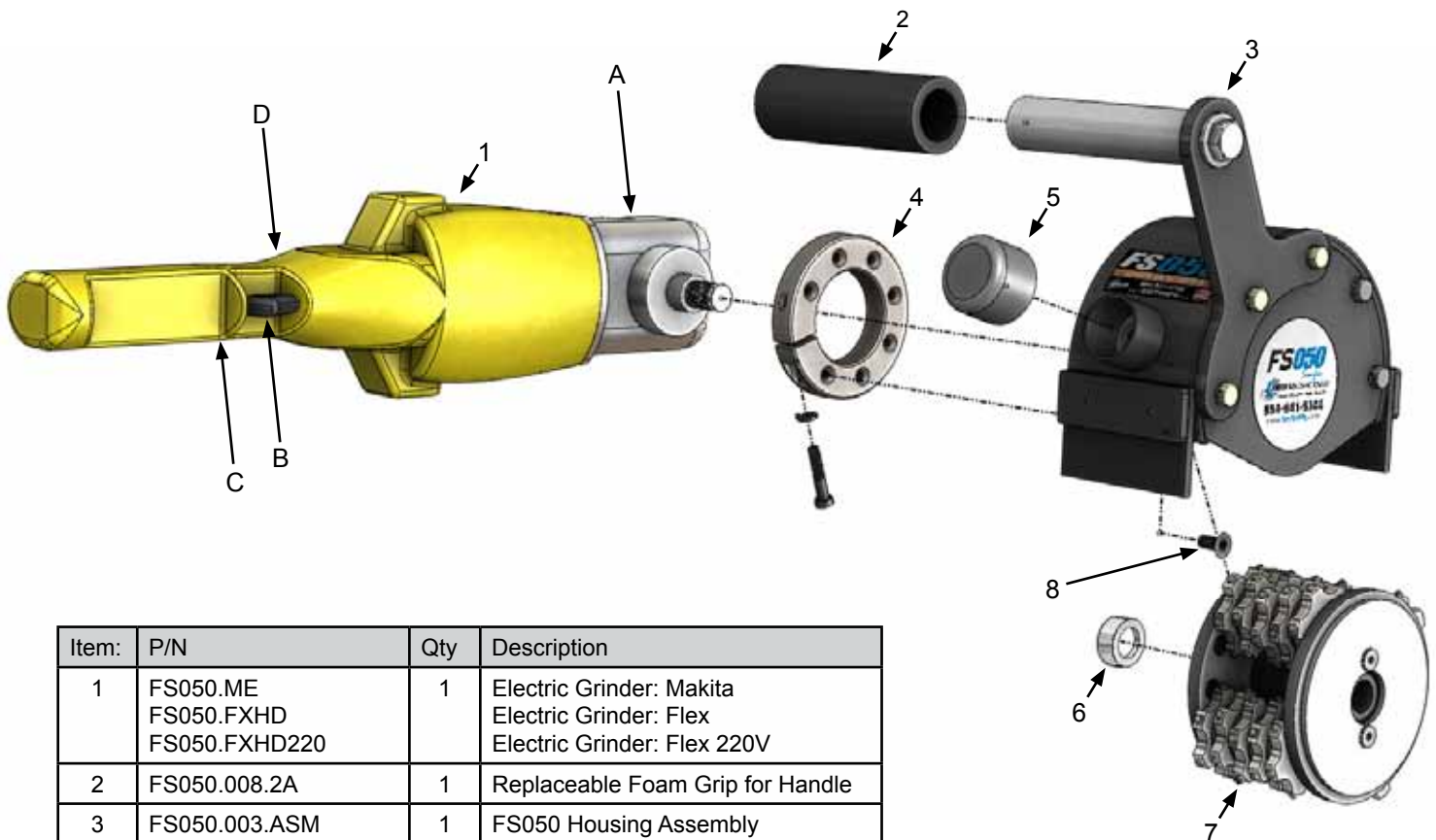

Item:	P/N	Qty	Description
1	FS050.ME FS050.FXHD FS050.FXHD220	1	Electric Grinder: Makita Electric Grinder: Flex Electric Grinder: Flex 220V
2	FS050.008.2A	1	Replaceable Foam Grip for Handle
3	FS050.003.ASM	1	FS050 Housing Assembly
4	FS050.005 FS050.005.FX FS050.006	1	Adapter: Makita Adapter: Flex Adapter: Dewalt
5	FS050.015	1	Vacuum Port Cap
6	FS050.005.2FX	1	Spacers
7	Varies	1	See FS050 Drum and Cutter Assemblies (see pg. 9 - 10)
8	FHSCS.M6-1.0x16mm	8	M6x1.0x16mm Flat Head Screw

Special Note: For Flex 220 (220V Model), special care must be taken when installing the Drum (item number 7). One side is tapped for M14-2.0, and one is tapped for 5/8-11. The drum should be attached to the machine carefully, feeling for the threads to engage correctly. The 14mm shaft on the 220V Flex will fit into the 5/8" end of the drum, but can strip the threads or lock the drum in place if improperly attached.

NOTE: Item 3 includes item numbers 2, 4, 5, 6, and 8

RECOMMENDATIONS

- **ELECTRICAL SAFETY:** Grounded tools must be plugged into an outlet properly installed and grounded in accordance with all codes and ordinances. Never remove the grounding prong or modify the plug in any way. Do not use any adaptor plugs. Check with a qualified electrician if you are in doubt as to whether the outlet is properly grounded. If the tools should electrically malfunction or break down, grounding provides a low resistance path to carry electricity away from the user.
- Avoid body contact with grounded surfaces such as pipes, radiators, ranges and refrigerators. There is an increased risk of electric shock if your body is grounded.
- Do not expose power tools to rain or wet conditions. Water entering a power tool will increase the risk of electric shock.
- Do not abuse the cord. Never use the cord to carry the tools or pull the plug from an outlet. Keep cord away from heat, oil, sharp edges or moving parts. Replace damaged cords immediately. Damaged cords increase the risk of electric shock.
- When operating a power tool outside, use an outdoor extension cord marked "W-A" or "W". These cords are rated for outdoor use and reduce the risk of electric shock.

USING THE FS050

- **PERSONAL SAFETY:** Stay alert, watch what you are doing and use common sense when operating a power tool. Do not use tool while tired or under the influence of drugs, alcohol, or medication. A moment of inattention while operating power tools may result in serious personal injury.
- Dress properly. Do not wear loose clothing or jewelry. Contain long hair. Keep your hair, clothing, and gloves away from moving parts. Loose clothes, jewelry, or long hair can be caught in moving parts.
- Avoid accidental starting. Be sure switch is off before plugging in. Carrying tools with your finger on the switch or plugging in tools that have the switch on invites accidents.
- Do not overreach. Keep proper footing and balance at all times. Proper footing and balance enables better control of the tool in unexpected situations.
- Use safety equipment. Always wear eye protection. Dust mask, non-skid safety shoes, hard hat, or hearing protection must be used for appropriate conditions. Ordinary eye or sun glasses are NOT eye protection.
- **WORK STATIONS:** Keep your work area clean and well lit. Cluttered benches and dark areas invite accidents.
- Do not operate power tools in explosive atmospheres, such as in the presence of flammable liquids, gases, or dust. Power tools create sparks which may ignite the dust or fumes.
- Keep bystanders, children, and visitors away while operating a power tool. Distractions can cause you to lose control.

DRUM OPTIONS

A variety of cutters with a 4 or 6 shaft set up is available for the FS050 to suit all your removal needs.

SCRAPE-IT

CF0409 - 10 Pointed Angled Edge Star, 100% sintered ultra-premium life, tungsten carbide cutter



Available in:

FINE FINISH	6 SHAFTED	4 SHAFTED
Drum assembly:	5502.6.0409.2F	5502.4.0409.2F
Rebuild kit:	FS050.6.0409.2F.RK	FS050.4.0409.2F.RK

MEDIUM FINISH	6 SHAFTED	4 SHAFTED
Drum assembly:	5502.6.0409.2M	5502.4.0409.2M
Rebuild kit:	FS050.6.0409.2M.RK	FS050.4.0409.2M.RK

COARSE FINISH	6 SHAFTED	4 SHAFTED
Drum assembly:	5502.6.0409.2C	5502.4.0409.2C
Rebuild kit:	FS050.6.0409.2C.RK	FS050.4.0409.2C.RK

CF0410 - 15 Pointed Straight Edge Star, 100% sintered ultra-premium life, tungsten carbide cutter



Available in:

FINE FINISH	6 SHAFTED	4 SHAFTED
Drum assembly:	5502.6.0410.2F	5502.4.0410.2F
Rebuild kit:	FS050.6.0410.2F.RK	FS050.4.0410.2F.RK

MEDIUM FINISH	6 SHAFTED	4 SHAFTED
Drum assembly:	5502.6.0410.2M	5502.4.0410.2M
Rebuild kit:	FS050.6.0410.2M.RK	FS050.4.0410.2M.RK

COARSE FINISH	6 SHAFTED	4 SHAFTED
Drum assembly:	5502.6.0410.2C	5502.4.0410.2C
Rebuild kit:	FS050.6.0410.2C.RK	FS050.4.0410.2C.RK

SCRAPE-IT

CF0411 - 15 Pointed Straight Edge Star, 100% sintered ultra-premium life, tungsten carbide cutter



Available in:

FINE FINISH	6 SHAFTED	4 SHAFTED
Drum assembly:	5502.6.0411.2F	5502.4.0411.2F
Rebuild kit:	FS050.6.0411.2F.RK	FS050.4.0411.2F.RK

MEDIUM FINISH	6 SHAFTED	4 SHAFTED
Drum assembly:	5502.6.0411.2M	5502.4.0411.2M
Rebuild kit:	FS050.6.0411.2M.RK	FS050.4.0411.2M.RK

COARSE FINISH	6 SHAFTED	4 SHAFTED
Drum assembly:	5502.6.0411.2C	5502.4.0411.2C
Rebuild kit:	FS050.6.0411.2C.RK	FS050.4.0411.2C.RK

FLAIL-IT

CF1519 - 8 spike extended tip ultra-premium life, tungsten carbide cutters



Available in:

FINE FINISH	6 SHAFTED	4 SHAFTED
Drum assembly:	5502.6.1519.2F	5502.4.1519.2F
Rebuild kit:	FS050.6.1519.2F.RK	FS050.4.1519.2F.RK

MEDIUM FINISH	6 SHAFTED	4 SHAFTED
Drum assembly:	5502.6.1519.2M	5502.4.1519.2M
Rebuild kit:	FS050.6.1519.2M.RK	FS050.4.1519.2M.RK

COARSE FINISH	6 SHAFTED	4 SHAFTED
Drum assembly:	5502.6.1519.2C	5502.4.1519.2C
Rebuild kit:	FS050.6.1519.2C.RK	FS050.4.1519.2C.RK



DRUM OPTIONS CONTINUED

FLAIL-IT

CF2516 - 6 spike ultra-premium life, tungsten carbide cutters



Available in:

FINE FINISH	4 SHAFTED
Drum assembly:	5502.4.2516.2F
Rebuild kit:	FS050.4.2516.2F.RK

MEDIUM FINISH	4 SHAFTED
Drum assembly:	5502.4.2516.2M
Rebuild kit:	FS050.4.2516.2M.RK

COARSE FINISH	4 SHAFTED
Drum assembly:	5502.4.2516.2C
Rebuild kit:	FS050.4.2516.2C.RK

STRIP-IT

CF2526 - 6 tooth ultra premium grade "full-width" tungsten carbide cutter



Available in:

FINE FINISH	4 SHAFTED
Drum assembly:	5502.4.2526.2F
Rebuild kit:	FS050.4.2526.2F.RK

MEDIUM FINISH	4 SHAFTED
Drum assembly:	5502.4.2526.2M
Rebuild kit:	FS050.4.2526.2M.RK

COARSE FINISH	4 SHAFTED
Drum assembly:	5502.4.2526.2C
Rebuild kit:	FS050.4.2526.2C.RK

FINISH-IT

HS0011 - Hardened Steel
SAW - tooth style
Ultra-Premium Grade Cutter



Available in:

FINE FINISH	4 SHAFTED
Drum assembly:	5502.4.0011.2F
Rebuild kit:	FS050.4.0011.2F.RK

MEDIUM FINISH	4 SHAFTED
Drum assembly:	5502.4.0011.2M
Rebuild kit:	FS050.4.0011.2M.RK

COARSE FINISH	4 SHAFTED
Drum assembly:	5502.4.0011.2C
Rebuild kit:	FS050.4.0011.2C.RK